

Note :-

- BUILDING WILL BE DESIGNED (STRUCTURES) AS PER RELEVANT IS CODES FOR EARTH QUAKE RESISTANCE.
- BUILDING IS HAS AUTOMATIC SPRINKLER SYSTEM ON ALL FLOORS.

LEGEND: =

Project:
 Revised building plan of group housing colony for an area measuring 34.0229 acres (License no.246 of 2007 dated 23.10.2007, License no.36 of 2011 dated 23.06.2011, License no. 37 of 2012 dated 22.04.2012, License no.66 of 2012 dated 21.06.2012, License no. 67 of 2012 dated 21.06.2012, License no. 43 of 2014 dated 16.06.2014 and License no.44 of 2014 dated 16.06.2014) Under TOD Policy dated 09.02.2016 in Sector-104, Gurugram Manesar Urban Complex being developed by Juventus Estate Ltd. and Others.

Associate Architects
RISIMIS ARCHITECTS
 RMS ARCHITECTS PVT. LTD.
 69, Nara Niwas, Bhawan Kurlj (Behind D2), Vasant Kurlj, New Delhi-110070.
 Tel.: 011-26898616, 26898617
 www.rms-arch.com

This is a "PERSONAL BUILDING PLAN" approved for the purpose of building for the personal use of the owner.
 It is not to be used for any other purpose.
 OWNERS SEAL & SIGNATURE
 ARCHITECT'S SEAL & SIGNATURE

FEB-2020 Scale : 1:200 Drawing No:- LOWER BASEMENT PLAN
 Drawing Title:- LOWER BASEMENT PLAN
 Revised Building Plan of Group Housing Colony for an area measuring 34.0229 acres in Sector-104, Gurugram Manesar Urban Complex being developed by Juventus Estate Ltd. and Others.
 (B MS)-104

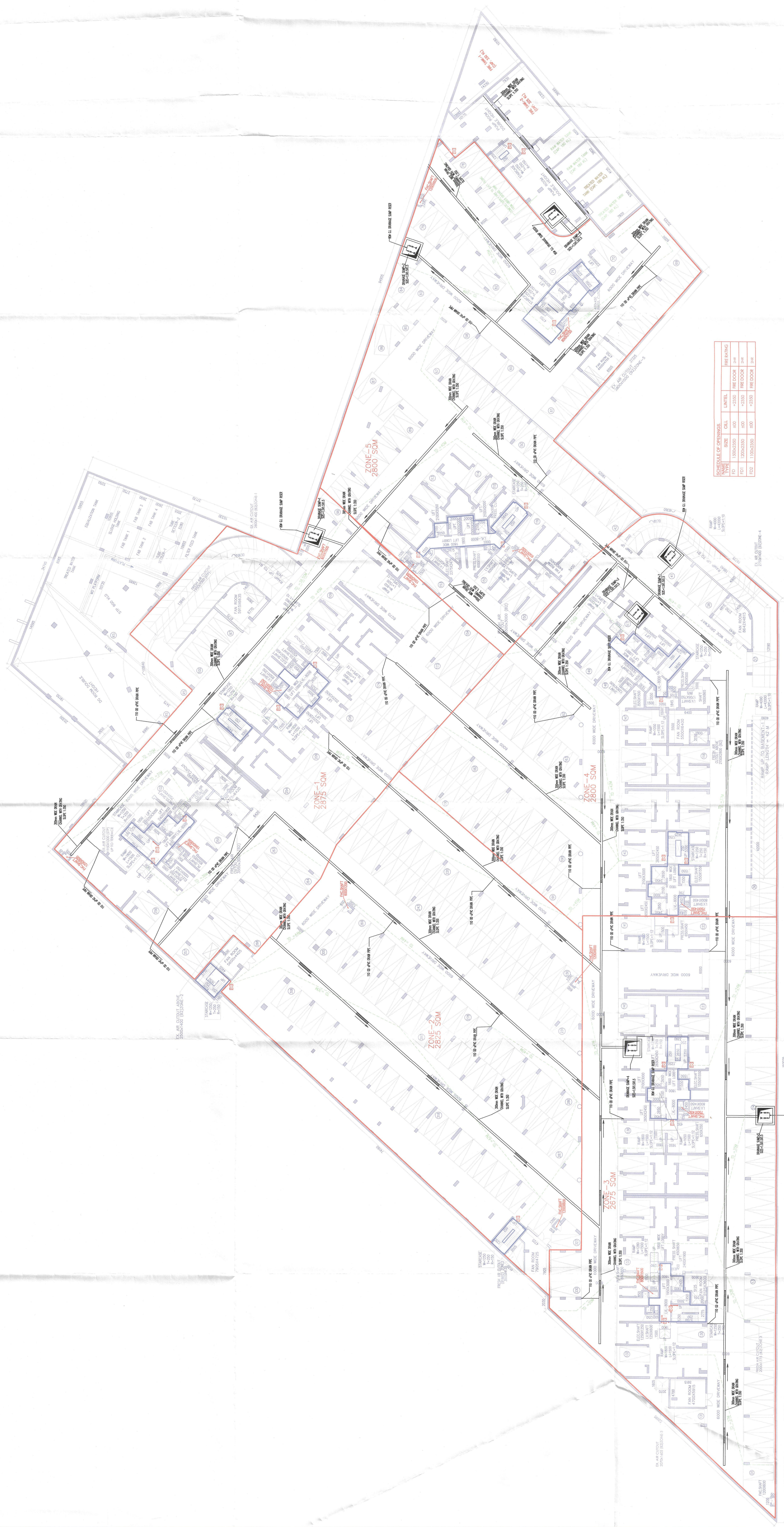

SCHEDULE OF OPENINGS

TYPE	SIZE	QTY	UNIT	REMARKS
FD	1000x2500	500	25000	PRE CAST
FD	1000x2500	500	25000	PRE CAST
FD	1000x2500	500	25000	PRE CAST

**LOWER BASEMENT PLAN
 LVL-8150
 TOTAL NO. OF PARKING -330**